

**ROTAX.**

TECHNICAL NOTE

No. 535-01

Page 1 of 4

Subject : Flywheel on drive side.

Models affected : Glider engines 535 series A and B, serial number V535/1407, 1408, 1428, 1429, 1485, 1497, 1499, 1532, 1552, 1553, 1554.

Reason : In consequence of torsional vibration resonance in the operating range, the crankshaft could get overloaded.

Compliance : Compliance is required by reaching of 10 engines hours or not later than June 30, 1984.

Instructions : 1) Remove magneto-flywheel from crankshaft, see repair procedure (pages 3 and 4), and check taper and wodruff key for damage. In case of no damage, remount magneto-flywheel. In the other case the engine must be repaired by Rotax.

2) Remove drive pulley from the crankshaft and mount pulley with additional flywheel as per drawing Skz. 2781 on page 2.

Weight change : Weight increases by 0,85 kg (1,87 lbs).

CG Position : Center of gravity must be checked.

Note : In case of the Janus CM, the tail load increases by 0,2 kg (0,44 lbs).

The drawing shows the situation of a HTD-toothed belt of 65 mm width. For the other belt dimensions, the flywheel has to be made accordingly.

The material is available by the aircraft manufacturer.

The work has to be performed by a competent person and has to be confirmed in the aircraft logbook.

Approved by

Bundesamt für Zivilluftfahrt

840131



Gunskirchen, 83 12 20

BOMBARDIER-ROTAX GMBH, A-4623 GUNSKIRCHEN, AUSTRIA

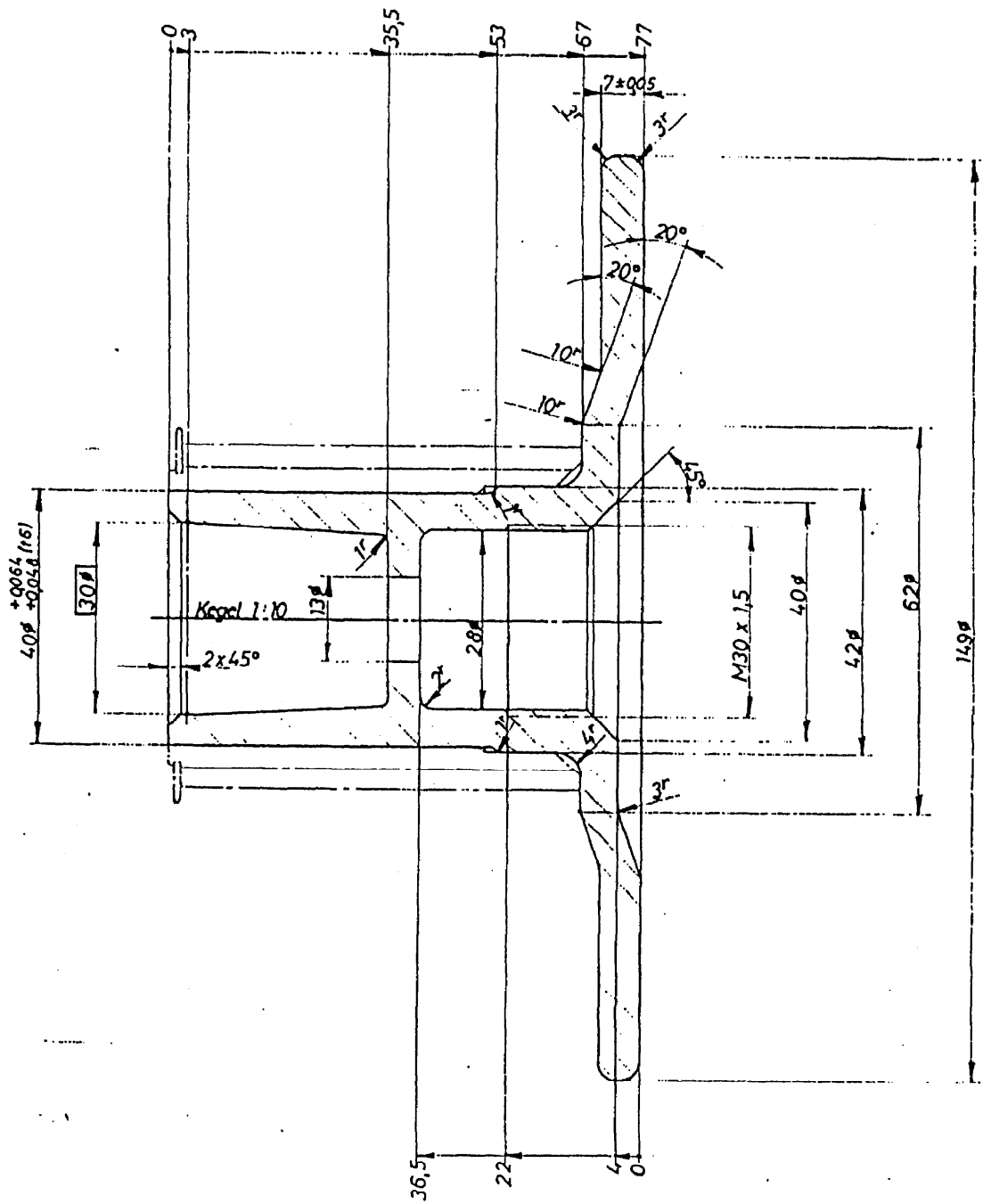

CK 45 heat treated

Flywheel

1:1 83 12 21

Skz. 2781



Repair instruction for disassembly and remounting of the magneto flywheel

1) Disassembly:

1.1. Remove cover washer (fig. 1)

Tools: Socket wrench 13 mm

1.2. Bolt flywheel holder to magneto flywheel with 3 hexhead screws M8 x 16 (fig. 2)

Tools: Flywheel holder 876 080
Socket wrench 13 mm

1.3. Unscrew hexagonal nut M22 x 1,5 (fig. 3)

Tools: Socket wrench 30 mm with extension
(torque wrench)

1.4. Fit protection mushroom to crankshaft, mount flywheel holder and puller and remove magneto flywheel (fig. 2)

Tools: Protection mushroom 876 557
Puller with flywheel holder and suitable extension
Wrench 22 mm

Note: To facilitate removal, the taper portion can be heated carefully to 120°C.

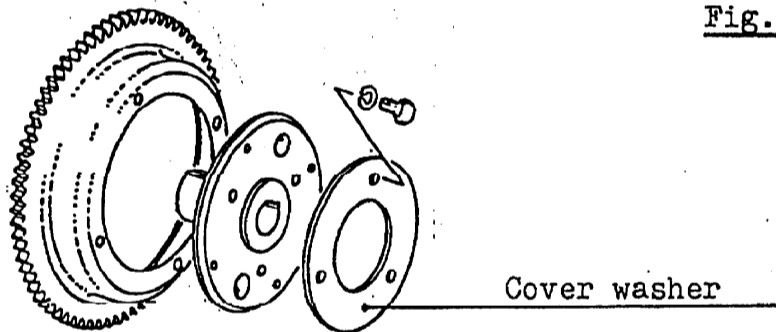

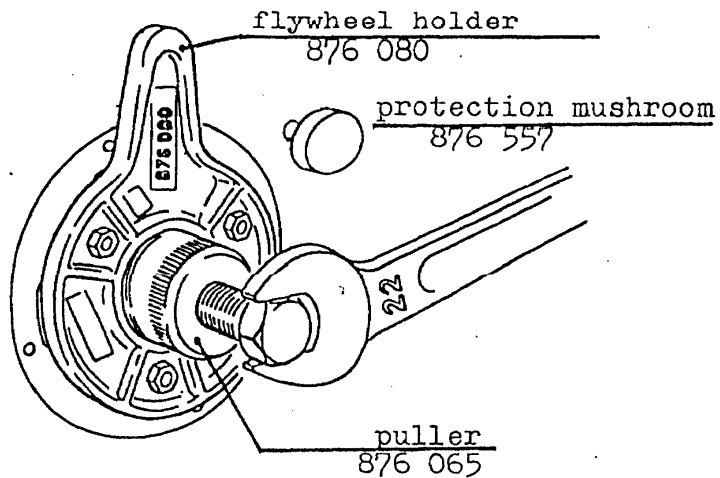

Fig. 2

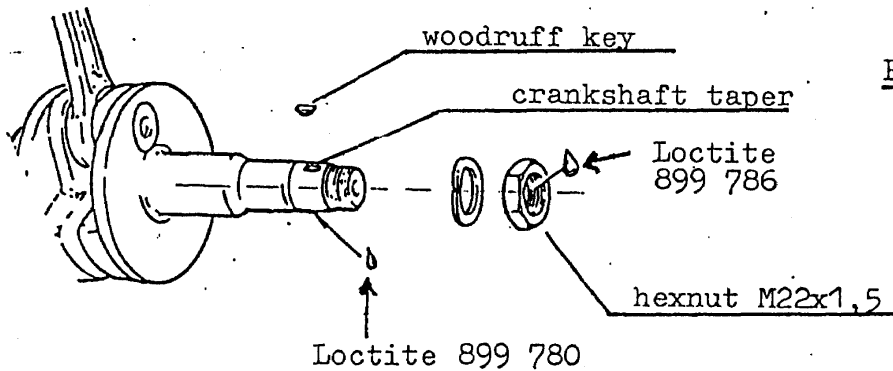

Fig. 3

2) Remounting of the magneto flywheel:

- 2.1. Degrease taper surface on crankshaft and magneto with solvent.
- 2.2. Insert woodruff key (fig. 3).
- 2.3. Apply Loctite 648, 899 780, on crankshaft taper.
- 2.4. Mount magneto flywheel assembled with magneto ring and starter gear on crankshaft.

Important: Before mounting check whether ignition unit and magneto is clean and free from particles.

- 2.5. Apply Loctite 241, 899 786, on thread of hexnut M22x1,5 and tighten with 14 kpm (100 ft lbs).

3) Allow 3 hours curing time for Loctite before operation.