

## SERVICE INSTRUCTION

# Introduction of a new regulator connector bracket assy. part no. 951983 for ROTAX® Engine Type 912 i (Series)

ATA System: 76-10-00 Fuse Box

### 1) Planning information

To obtain satisfactory results, procedures specified in this publication must be accomplished with accepted methods in accordance with prevailing legal regulations.

BRP-Rotax GmbH & Co KG cannot accept any responsibility for the quality of work performed in accomplishing the requirements of this publication.

#### 1.1) Applicability

All versions of ROTAX® engines types:

Engine type	Serial number
912 iSc Sport	all
912 iS	all
912 iS Sport	all

#### NOTICE

**The new regulator connector bracket assy. is not a part of the Engine Type Design or ASTM compliance and is NOT certified/compliant for ROTAX® 912 i (Series).**

The certification of the connector bracket assembly is the responsibility of the aircraft manufacturer and must be carried out jointly with the aircraft.

#### 1.2) Concurrent ASB/SB/SI and SL

None.

#### 1.3) Reason

In the course of continuous development and standardization, a new connector bracket assembly (part no. 951983) has been introduced as an optional extra. Depending on the installation situation this bracket provides a convenient and secure location to which the stator/regulator connector can be attached.

#### 1.4) Subject

Introduction of a new regulator connector bracket assy. part no. 951983 for ROTAX® Engine Type 912 i (Series).

#### 1.5) Compliance

NONE - For Information Only.

#### WARNING

Non-compliance with these instructions could result in engine damages, personal injuries or death.

The general safety information must be observed for all work on the aircraft engine and its surrounding components.

d06436.fm

# SERVICE INSTRUCTION

---

## 1.6) Approval

The technical content of this document is approved under the authority of DOA ref. EASA.21J.048.

## 1.7) Labor time

Estimated labor hours:

Engine installed in the aircraft - - - labor time will depend on airframe installation and therefore no estimate is available from the engine manufacturer.

## 1.8) Mass data

change of weight - - - none.

moment of inertia - - - unaffected.

## 1.9) Electrical load data

No change.

## 1.10) Software modifications

No change.

## 1.11) References

In addition to this technical information refer to current issue of

- Illustrated Parts Catalog (IPC)
- Installation Manual (IM)
- Maintenance Manual Line (MML)
- Maintenance Manual Heavy (MMH)

NOTE: The status of the Manuals can be determined by checking the table of amendments. The 1<sup>st</sup> column of this table shows the revision status. Compare this number to that listed on the ROTAX website: [www.FLYROTAX.com](http://www.FLYROTAX.com). Updates and current revisions can be downloaded for free.

## 1.12) Other Publications affected

None.

## 1.13) Interchangeability of parts

- All parts are interchangeable

# SERVICE INSTRUCTION

## 2) Material Information

### 2.1) Material- cost and availability

Price and availability will be provided on request by ROTAX® Authorized Distributors or their independent Service Centers.

### 2.2) Company support information

None.

### 2.3) Material requirement per engine

parts requirement:

Fig.no.	New p/n	Qty/ engine	Description	Old p/n	Application
2, 3	951983	2	Connector bracket assy.	-	Fuse Box

### 2.4) Material requirement per spare part

None.

### 2.5) Rework of parts

None.

### 2.6) Special tooling/lubricant-/adhesives-/sealing compound/price and availability

None.

d06436.fm

# SERVICE INSTRUCTION

## 3) Accomplishment/Instructions

NOTE: Before maintenance, review the entire documentation to make sure you have a complete understanding of the procedure and requirements.

### Accomplishment

All measures must be implemented and confirmed by at least one of the following persons or organizations:

- ROTAX® - Airworthiness representatives
- ROTAX® - Authorized Distributors or their independent Service Centers
- Persons approved by the respective Aviation Authority
- Persons with approved qualifications for the corresponding engine types. Only authorized persons (iRMT, Level Minimum Line Maintenance) are entitled to carry out this work.
- Persons with type-specific training

NOTE: All work has to be performed in accordance with the relevant Maintenance Manual.

### Safety notice

#### WARNING

Identifies an instruction which, if not followed, may cause serious injury or even fatal injury.

#### CAUTION

Identifies an instruction which, if not followed, may cause minor or moderate injury.

#### NOTICE

Identifies an instruction which, if not followed, may severely damage the engine or could void any warranty.

#### **ENVIRONMENTAL NOTE**

Environmental notes give you tips on environmental protection.

NOTE: Indicates supplementary information which may be needed to fully complete or understand an instruction.

### 3.1) Instruction - related information

NOTE: The regulators' female connector housing (Black for regulator A, part no. 864392, Grey for regulator B part no. 864396) already have a molded clip that attaches securely to the new regulator connector bracket assembly part no. 951983.  
See Fig. 2 and see also latest Illustrated Parts Catalog of 912 i Series, chapter 76-10-00.

# SERVICE INSTRUCTION

## 3.2) Maintenance (Line) - related information

See relevant Maintenance Manual (Line) for the respective engine type and its periodical maintenance information.

Points of inspection	Interval Operating hours		Chapter reference
	100 h	200 h	
Visual inspection of the wiring harness, connectors and brackets for secure fit, damage and signs of wear.	X		12-20-00 section 15.1

## 3.3) Maintenance (Heavy) - related information

See Fig.1 and Fig. 2.

To install this optional extra part(s) following jobs tasks need to be performed:

Step	Procedure
1	Remove lock nut M6 (1).
2	Remove washer 6.4 (2).
3	Install the new regulator connector bracket (Fig. 2, pos. 2) and position correct.
4	Fasten regulator o the fuse box with lock nut M6 again. Wrench size: A/F 10. Tightening torque: 6 Nm (53 in. lb). NOTE: Tighten the two lock nuts M6 alternately to ensure a smooth seat of rectifier regulator on the regulator plate.

## 3.4) Test run

Conduct test run. See chapter 12-20-00 of the latest Maintenance Manual Line for the respective engine type.

## 3.5) Summary

These instructions (section 3) have to be followed in accordance with the deadlines specified in section 1.5.



A revision bar outside of the page margin indicates a change to text or graphic.

Translation into other languages might be performed in the course of language localization but does not lie within ROTAX® scope of responsibility.

In any case the original text in English language and the metric units are authoritative.

## 3.6) Inquiries

Inquiries regarding this Service Instruction should be sent to the ROTAX® Authorized Distributor of your area.

A list of all ROTAX® Authorized Distributors or their independent Service Centers is provided on [www.FLYROTAX.com](http://www.FLYROTAX.com).

# SERVICE INSTRUCTION

## 4) Appendix

The following figure should provide additional information:

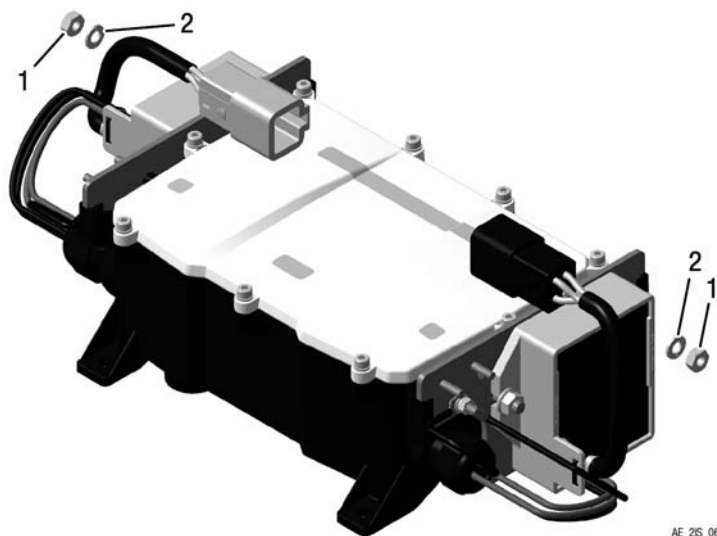

Fig. 1

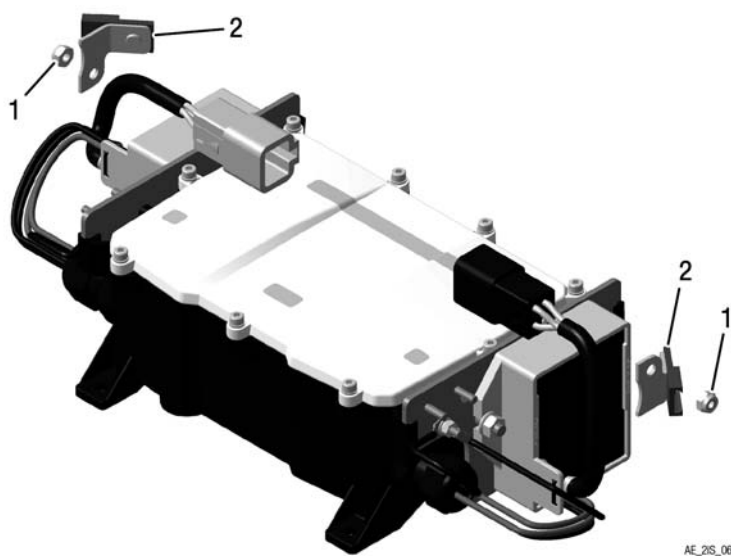

Fig. 2

d06436.fm

# SERVICE INSTRUCTION

---

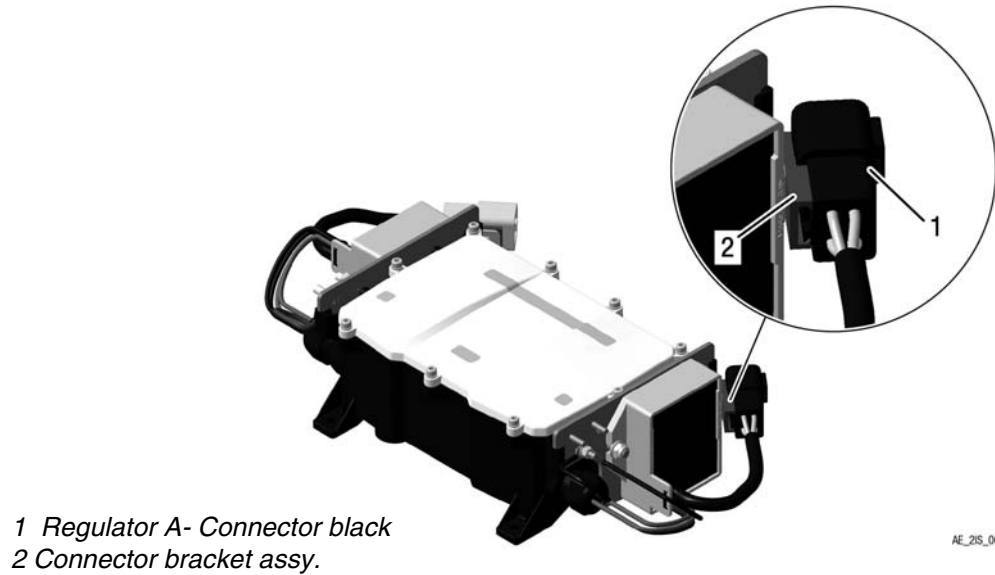

Fig. 3

---

**NOTE:** The illustrations in this document show the typical construction. They may not represent full detail or the exact shape of the parts which have the same or similar function.

Exploded views are **not technical drawings** and are for reference only. For specific detail, refer to the current documents of the respective engine type.